

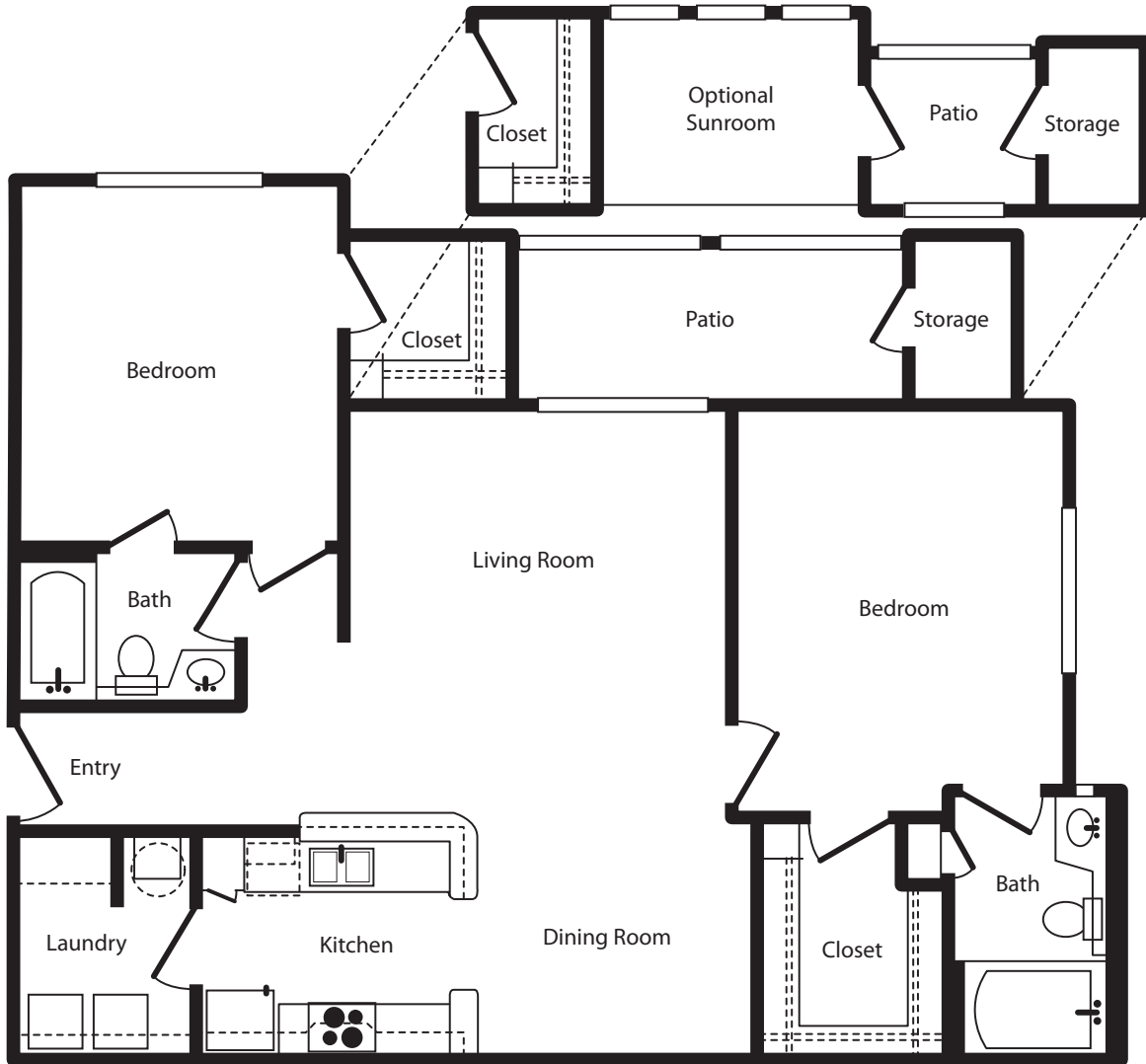

# PROVIDENCE PARK

• APARTMENT HOMES •



## Windsor

\_\_\_\_\_ SF | \$ \_\_\_\_\_

### 2 BEDROOM • 2 BATH

for residential inquiries, please email [info@providenceparkapartments.com](mailto:info@providenceparkapartments.com)  
All measurements, floorplans and amenities are approximate and subject to change without notice.

The depiction and information on the property is based on plans and should not be relied upon as actual representations of the real estate planned to be constructed and offered for sale. This does not constitute an offer to sell real estate. We reserve the right to alter the specifications depicted or described in whole or in part without notice or obligation. This is not an offer or solicitation in any jurisdiction in which the legal requirements for such an offering have not been met. © 2014 Providence Park Apartments

